

◆ WWC ◆

*Western Window Coverings, Inc.*



**Roller Shade** Balance translucency and opacity for reduced glare and enhanced privacy. Achieve a sleek and modern atmosphere with their minimalist design.

# Roller Shade

Roller Shade is available in two different design options, standard exposed roll and cassette with matching fabric inserts. The innovative CSA-153™ cassette system features unique solutions to provide for ease of installation.

- Cassette & Bottom Rail with Matching Fabric Insert.
- Cordless operation.
- Clutch/Retractable wand operated shades.
- Motorized operation utilizes industry leading motors known for their quiet operation and ease of use.
- Standard Exposed Roll Configuration
- Square and Rounded (CSA-153™) Cassette options.
- Standard or Reverse Roll.

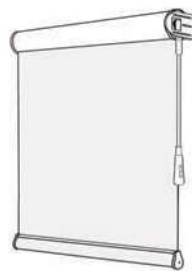

Standard Exposed Roll Wand Operated Motorization

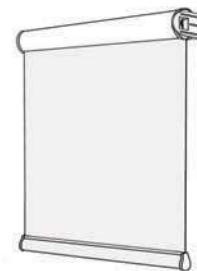

Standard Exposed Roll Remote Operated Motorization



Rounded Cassette with Retractable Wand

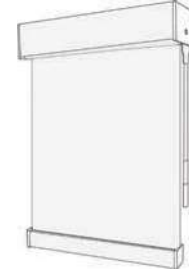

Square Cassette with Retractable Wand



Rounded Cassette with Cordless Operation

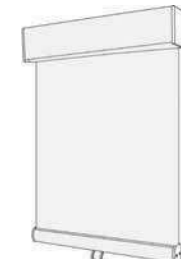

Square Cassette with Cordless Operation



Rounded Cassette with Wand Operated Motorization



Square Cassette with Wand Operated Motorization



Rounded Cassette with Remote Operated Motorization

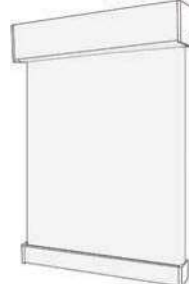

Square Cassette with Remote Operated Motorization

# Roller Shade System

## Product Component Overview

1. Cassette
2. Bottom rail
3. Cassette End Cap (Right)
4. Cassette End Cap (Left)
5. Bottom Rail End Cap (Right)
6. Bottom Rail End Cap (Left)
7. Bottom Rod
8. Tube (38mm)
9. Inner Bracket (L)
10. Clutch (38mm)
11. Idle End Plug
12. Retractable Wand
13. Mounting Bracket
14. Bi-Directional Installation Clip
15. Level Controller Cap
16. Remote

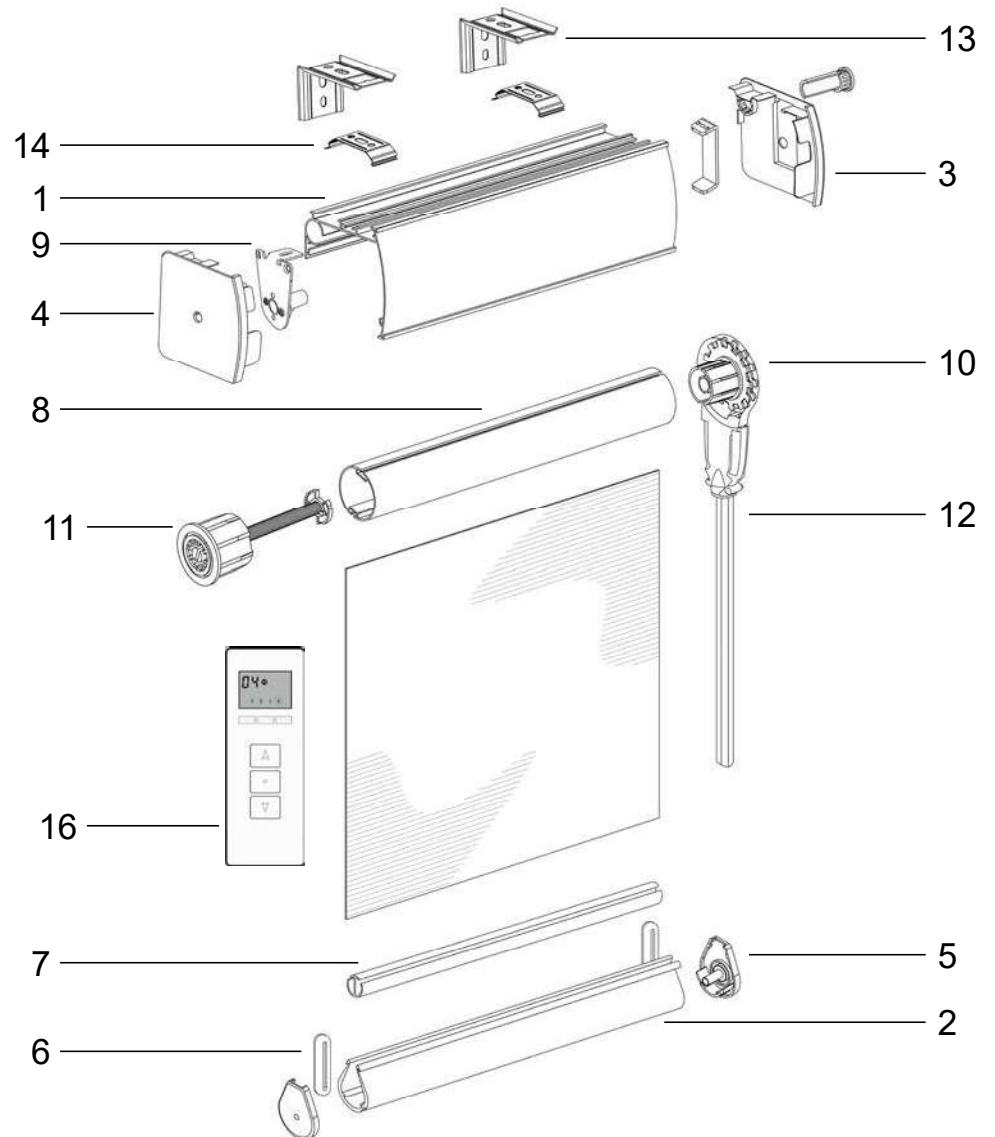

## Minimum Size

Clutch operated with retractable wand	8" x 16"
Rechargeable Battery Motor	22 1/2" x 16"
Wand Operated Motor	22 1/2" x 16"
Hardwired DC Motor	15 5/8" x 16"
Cordless	21" x 16"

\*Please refer to Fabric Technical Data pg. CO-10 for further information regarding maximum shade sizing.

## Standard Cord Length

Shade Height Cord Length	
18"-27 7/8"	18"
28"-39 7/8"	24"
40"-59 7/8"	36"
60"-83 7/8"	48"
84"-107 7/8"	60"
108" and over	72"

\*Surcharge of \$8.00 will apply to any cord or metal chain measuring above 97" to 140". \*\*All continuous cords will be matched to the appropriate component color. Please refer to "Color Table and Fabric Technical Data" see pg. RO-07

## Available Design Options

- Cassette with standard matching fabric insert for both cassette and bottom rail.
- Standard Exposed Roll
- Standard or reverse roll

## Tube Size

Shade Size	Internal Dimension	Outside Dimension
Up to 78"	36mm	38mm
78 1/8" & above	38mm	40mm

## Bracket Requirements

Shade Size	# of Brackets
Up to 40"	2
40 1/8" - 70"	3
70 1/8" - 96"	4

## Component Color Option

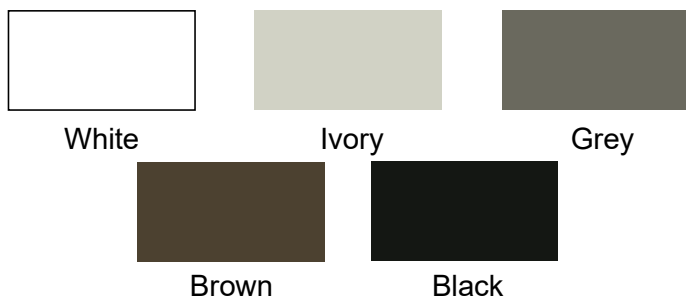

## Finished Dimensions

	Inside Mount	Outside Mount	End Mount
	(IM)	(OM)	(EM)
All systems	-1/8"	-0"	-5/8"
Shade height	-1/8"	-0"	-1/8"
Fabric width	-1 3/16"	-1 3/16"	-1 9/16"

## Mounting Requirements

### Rounded Cassette (CSA-153)

Inside Mount	
Minimum Casement Depth	2"
Fully Recessed	3 5/8"
Outside Mount	
Minimum Mounting Surface Height	1 3/4"
End Mount	
Minimum Casement Depth	2"

### Standard Exposed Roll

Inside Mount	
Minimum Casement Depth	2"
Fully Recessed	3 5/8"
Outside Mount	
Minimum Mounting Surface Height	1 3/4"
End Mount	
Minimum Casement Depth	2"

## Retractable Wand Length

16"-47 7/8"	24"
48"-71 7/8"	36"
72" and above	48"

\*All retractable wands will be matched to the appropriate component color. Please refer to "Color Table" see page CO-08 to CO-09.

## Motorization Wand Length

16"-47 7/8"	24"
48"-71 7/8"	36"
72" and above	48"

\*Motorization wands are available in white only

## Child Safety Tension Device

---

In accordance with the revised American National Standard (ANSI WCMA A100.1- 2018) for Safety of Corded Window Covering Products, Combi Shade® requires proper mounting of the tension device on cords that exceed 40% of the shades height for the product to function safely and properly. Tension devices should not be modified in any way.

## Light Gap (Cassette)

---

Light gap is measured from the edge of the window opening to the edge of fabric.

**Retractable Wand** (Inside Mount)

Clutch Side ..... 1/2"  
End Plug Side ..... 5/8"

**Cordless Wand** (Inside Mount)

Clutch Side ..... 1/2"  
End Plug Side ..... 5/8"

**Motorization** (Inside Mount)

Clutch Side ..... 1/2"  
End Plug Side ..... 5/8"

## Light Gap (Standard Exposure Roll)

---

Light gap is measured from the edge of the window opening to the edge of fabric.

**Retractable Wand** (Inside Mount)

Clutch Side ..... 1/2"  
End Plug Side ..... 5/8"

**Cordless Wand** (Inside Mount)

Clutch Side ..... 1/2"  
End Plug Side ..... 5/8"

**Motorization** (Inside Mount)

Clutch Side ..... 1/2"  
End Plug Side ..... 5/8"

## Tile Cut

Upon request, the bottom bar assembly and fabric can be cut down to a specified size, different from the width of the cassette assembly.

### Measuring and ordering “Tile Cut”.

#### Step 1

Measure the uppermost position “A” of the window opening to determine the window opening size.

#### Step 2

Measure the inside width of the window opening at the lowermost position “B” to determine the bottom window opening size

#### Step 3

Please specify the determined width of the lowermost position under “tile cut” column.

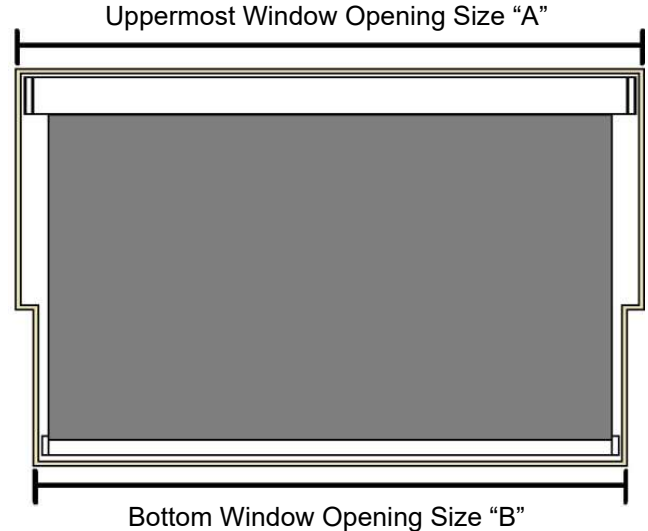

## Measuring Corner Windows

There are a few different approaches to measuring for corner windows. Please consider the formed light gap in relation to viewing angle from both inside and outside and how this might affect privacy.

### Options 1 & 2

#### Step 1

Measure the inside width of both window openings at the uppermost position to determine the widths of the cassette.

#### Step 2

Decide which of the two shades will be full or butt shade.

#### Step 3

Deduct 3  $\frac{5}{8}$ ” from the determined width of the butt shade.

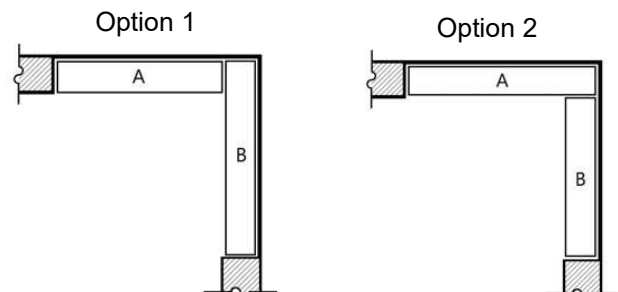

### Option 3

#### Step 1

Measure the inside width of both window openings at the uppermost position to determine the widths of the cassette.

#### Step 2

Once both measurements are acquired, deduct 3  $\frac{5}{8}$ ” from both shades.

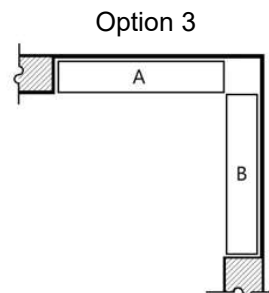

### Important!

This option will greatly increase the amount of light gap formed along the corner.

## Price Group A

### Standard Exposed Roll

Bantry, Yap, Omega 1%, 3%, 5%

WIDTH UP TO:	36	42	48	54	60	66	72	78	84	90	96
<b>42</b>	151	176	200	225	251	276	300	325	351	376	400
<b>48</b>	170	200	229	257	286	315	343	373	400	430	458
<b>54</b>	192	225	257	290	322	355	386	419	451	484	515
<b>60</b>	215	251	286	322	358	393	430	465	501	537	573
<b>66</b>	235	276	315	355	393	433	473	512	553	590	631
<b>72</b>	257	300	343	386	430	473	515	558	602	645	688
<b>78</b>	278	325	373	419	465	512	558	606	653	698	745
<b>84</b>	300	351	400	451	501	553	602	653	702	753	802
<b>90</b>	322	376	430	484	537	590	645	698	753	806	859
<b>96</b>	343	400	458	515	573	631	688	745	802	859	918
<b>102</b>	365	425	488	547	608	670	731	792	853	913	975
<b>108</b>	386	451	515	580	645	710	774	837	902	967	1032
<b>114</b>	408	476	545	612	680	748	818	885	953	1021	1089
<b>120</b>	430	501	573	645	718	788	859	932	1002	1075	1147

## Price Group B

### Fabric Covered Casette

Bantry, Yap, Omega 1%, 3%, 5%

WIDTH UP TO:	36	42	48	54	60	66	72	78	84	90	96
<b>42</b>	187	218	251	282	313	345	376	407	439	471	501
<b>48</b>	215	251	286	322	358	393	430	465	501	537	573
<b>54</b>	242	282	322	361	402	442	484	524	564	605	645
<b>60</b>	268	313	358	402	447	491	537	581	627	671	718
<b>66</b>	295	345	393	442	491	541	590	640	689	738	788
<b>72</b>	322	376	430	484	537	590	645	698	753	806	859
<b>78</b>	348	407	465	524	581	640	698	757	814	872	932
<b>84</b>	376	439	501	564	627	689	753	814	878	941	1002
<b>90</b>	402	471	537	605	671	738	806	872	941	1008	1075
<b>96</b>	430	501	573	645	718	788	859	932	1002	1075	1147
<b>102</b>	456	532	608	685	762	837	913	991	1066	1141	1218
<b>108</b>	484	564	645	724	806	887	967	1048	1130	1209	1290
<b>114</b>	510	595	680	764	852	936	1021	1106	1191	1275	1362
<b>120</b>	537	627	718	806	896	985	1075	1165	1255	1344	1433

**Note**

Product price only, does not include freight, state/local taxes, measuring and installation, and other services associated with custom installation.



## Roller Shade Color Table

Product Name	Color	Color Name	Component Color
<b>BANTRY</b> <b>DECK# R-01</b> 26050	BT-01	White	White
	BT-02	Cream	Ivory
	BT-03	Beige	Ivory
	BT-04	Grey	Grey
	BT-05	Charcoal	Grey
<b>YAP</b> <b>DECK# R-02</b> 28040	YP-01	White	White
	YP-02	Ivory	Ivory
	YP-03	Sand	Ivory
	YP-04	Grey	Grey
	YP-05	Green	Ivory
	YP-06	Brown	Brown
	YP-07	Charcoal	Black
<b>OMEGA</b> 1%, 3%, 5% <b>DECK# R-03</b> SC-A230030	OM-301	White	White
	OM-302	White/Ivory	Ivory
	OM-303	White/Grey	Grey
	OM-304	Ivory	Ivory
	OM-308	Black/Bronze	Brown
	OM-310	Black/Grey	Grey
	OM-311	Black	Black

## Fabric Technical Data (Standard Exposed Roll)

Color Deck #	Pattern Name	Fabric Info	Maximum Width (in)	Maximum Length (in)	Maximum sqft.	Weight: (g/m2)	Thickness	Packing	Fire Retardant	Qty of Colors
R-03	OMEGA 1%,3%,5%	SC-A2/30030	96"	120"	68 sqft.	468 g/m2 (±5%)	0.029" (±5%)	118" x 32.81yd /Roll	NFPA701 (USA)	7

## Fabric Technical Data (Fabric Covered Cassette)

Color Deck #	Pattern Name	Fabric Info	Maximum Width (in)	Maximum Length (in)	Cordless**		Maximum sqft.	Weight: (g/m2)	Thickness	Packing	Fire Retardant	Qty of Colors
					Max Width	Max Height						
R-03	OMEGA 1%,3%,5%	SC-A2/30030	96"	120"	72"	76"	68 sqft.	468 g/m2 (±5%)	0.029" (±5%)	118" x 32.81yd /Roll	NFPA701 (USA)	7

### Note

\*All Fabric Compositions are 100% Polyester unless stated otherwise.

(OMEGA 1% 3%, 5%: 30%Polyester / 70% PVC)

\*\*Maximum allowable height for cordless will vary depending on ordered width. Please refer to the detailed cordless specification sheet for further information.



# Surcharges

Combi Shade®, Roller Shade, Triple Shade™

## Standard Features Included

Installation Brackets  
Tension Device  
Level Controller  
ILS (Internal Limit Stop)  
Matching Fabric Insert for Cassette and  
Bottom Rail

## Optional Features (No Charge)

Hold Down Brackets  
Extended OM Brackets  
Spacer Blocks  
Side-By-Side (see Measurement page)  
Tile Cut (see Measurement page)  
Change cord size (additional 1 foot)

## Optional Accessory Surcharges

Oval Free Hang .....	\$ 5/unit
Motorization .....	Please refer to motorization pricing below
Metal Chain .....	\$6.60/foot
Cordless .....	\$40.00 each



## Motorization Pricing

\*\* not applicable with Veilette™

<b>Parts</b>	<b>Cost</b>
Motor (Rechargeable) .....	\$440
Motor (12V) .....	\$600
Motor (Wand Controlled Rechargeable)* .....	\$370
ALDC Recharger & Angled Adapter (set) .....	\$70
10ft ALDC Extension Cable (ea.) .....	\$45
1 Channel Hand Held Remote - RE301 (ea.) .....	\$90
5 Channel Hand Held Remote - RE302 (ea.) .....	\$110
8 Channel Hand Held Remote - RE303-8c (ea.) .....	\$160
16 Channel Hand Held Remote - RE303-16c (ea.) .....	\$200
1 Channel Wall Mount Control - RE201 (ea.) .....	\$100
2 Channel Wall Mount Control - RE202 (ea.) .....	\$120
8 Channel Wall Mount Control - RE203-8C (ea.) .....	\$170
Avant Wifi Hub (ea.) .....	\$500

Disclaimer - Perfect synchronization of movement between multiple motorized shades will not be possible due to a variety of factors such as varying response time and potential interference.

### Note

\*Wand controlled motor is only operable by the control buttons located on the wand, and does not sync to any other available accessories (i.e. remote, wall mount, hub).

**Please apply your discount rates for all motorization parts and accessories.**

Note: When ordering motorized shades, please refer to Fabric Technical Data for additional information.

## Avant Motorized Controllers

Combi Shade® motorized shade systems offer consumers the option of integrating their motorized shades with a compatible smart home application through the use of Neo Link Box. This small and innovative device modernizes the way consumers can operate their shades, by providing access from a smart device. Simply download the free Neo app thru Google play or Apple App store. Once set up, consumer will have the ability to control one or various shades through their smart devices remotely. In addition, the Neo link box may be integrated for voice command through Amazon Alexa, Control4, Google Home, and Savant.

### Controller Options



1 Channel Handheld Remote RE301



5 Channel Handheld Remote RE302



8 Channel Handheld Remote RE303-8c



Wand Controller  
Available in 3 lengths:  
24", 36", 48"

### Wall Mount Controller Options



1 Channel Wall Mount Control RE201



2 Channel Wall Mount Control RE202



8 Channel Wall Mount Control RE203-8c

### Hub/Wifi Controller



Avant Wifi Hub



CR2032

Remotes and controllers utilize CR2032.